



Applications

Sleeves are used to create loop ends on wire rope slings. They are available in two types and in various sizes.

Range

Van Beest offers sleeves in aluminium and carbon steel.

Design

Aluminium wire rope sleeves are manufactured according to DIN 3093 A. For safety during fabrication and application they are of seamless construction.

Prescon carbon steel sleeves are manufactured from carbon steel. They include the Swaging Verification System, in which the colour intensity changes after swaging. This system helps the sling manufacturer to determine whether or not the sleeve has been pressed.

The sleeves are of seamless construction and fit industry standard dies.

Finish

Aluminium sleeves are self coloured.

The smaller dimensions of Prescon sleeves (up to and including 16 mm) are colour coded, larger dimensions are self coloured.

Certification

Specific details of certificate availability can be found on each product page. Please verify your certification requirements with Van Beest at time of order.

Instructions for use

For Aluminium sleeves, please refer to EN13411-3

Prescon sleeves are suitable for:

- 6 x 19 and 6 x 37 IWRC right regular lay EIPS steel wire rope
- 6 x 19 and 6 x 37 FC IPS right regular lay steel wire rope

After creating a loop end multiple progressive pressings are required to prevent flash, which will develop into a permanent mark or possibly a crack in the sleeve.

A light oil lubricant should be applied to each die before pressing. The sleeve must be cleaned after the swaging operation to stimulate effective colour change.

Colour change is not an indication for proper swaging, only an indication that the sleeve has been pressed.

Proper swaging practices are the sling manufacturer's responsibility. Before using sleeves with other type lay, construction or grade of wire rope, it is recommended that the termination be proof loaded to prove the adequacy of the assembly.

Regular inspection of the swaging machine, dies etc. must be conducted to ensure that the equipment continues to meet required standards.

4

5

6

7

8

9

10

11

12

13

14

15

16

17

18

19

20



S-6500

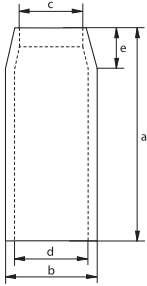

Prescon sleeves

for wire rope

- **Material** : special carbon steel
- **Finish** : up to and including size 16 mm colour coded
sizes above 16 mm self coloured
- **Certification** : 2.1

diameter wire rope	length	diameter outside	diameter inside	diameter inside	length	diameter outside pressed	weight per 100 pcs
mm	a mm	b mm	c mm	d mm	e mm	mm	kg
6	25.4	16.7	8.3	11.9	7.1	12.7	2.15
8	38.1	23	11.1	15.5	11.1	18.5	6.5
10	38.1	23	11.9	16.7	11.1	18.5	5.5
11	51	31	14.3	21.4	15.1	24.9	11.3
13	51	31	15.9	23	15.1	24.9	12.5
14	70	37	17.5	26.2	17.9	30.5	19.5
16	70	37	19.1	27.8	17.9	30.5	25.9
19	81	43.6	23.4	32.5	21.8	35.8	39.9
22	90	51.6	26.2	38.9	25.4	41.4	62
25	102	58	29.4	43.7	28.6	47.8	85
28	122	64	32.5	49.2	31.8	53	118
32	132	71	36.5	55	35.7	58	154
34 - 35	148	76	39.7	60	39.7	62	195
37 - 38	159	83	42.9	66.7	42.9	67	227
44 - 45	184	102	49.2	79	50	77	367
50 - 52	216	111	57	92	57	89	510
56 - 57	243	128	64	102	64	103	862
62 - 64	267	140	70	114	71	113	1043
68 - 70	292	146	76	121	79	118	1270
75 - 76	305	152	83	127	86	124	1334
87 - 89	356	178	98	148	100	145	2105
93 - 95	381	191	103	160	108	156	2495
100 -102	406	206	111	173	114	180	3130
112 -114	457	232	124	194	129	187	4536

4

5

6

7

8

9

10

11

12

13

14

15

16

17

18

19

20



A-6550

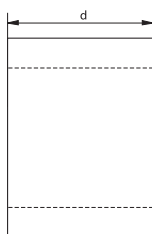
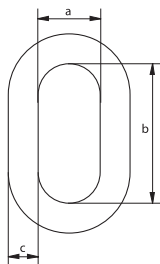

Aluminium sleeves

for wire rope

- **Material** : aluminium
- **Standard** : EN 13411-3 formerly DIN 3093 A
- **Finish** : self coloured
- **Certification** : 2.1

diameter wire rope	diameter	width	thickness	length	weight per 1000 pcs
mm	a mm	b mm	c mm	d mm	kg
1	1.2	2.4	0.65	5	0.1
1.5	1.7	3.4	0.75	6	0.21
2	2.2	4.4	0.85	7	0.24
2.5	2.7	5.4	1.05	9	0.5
3	3.3	6.6	1.25	11	0.84
3.5	3.8	7.6	1.5	13	1.32
4	4.4	8.8	1.7	14	2
4.5	4.9	9.8	1.9	16	2.61
5	5.5	11	2.1	18	5
6	6.6	13.2	2.5	21	5
6.5	7.2	14.4	2.7	23	7.55
7	7.8	15.6	2.9	25	9.53
8	8.8	17.6	3.3	28	15
9	9.9	19.8	3.7	32	19.8
10	10.9	21.8	4.1	35	25
11	12.1	24.2	4.5	39	35.8
12	13.2	26.4	4.9	42	45.8
13	14.2	28.4	5.4	46	59.7
14	15.3	30.6	5.8	49	73.5
16	17.5	35	6.7	56	111
18	19.6	39.2	7.6	63	159
20	21.7	43.4	8.4	70	220
22	24.3	48.6	9.2	77	280
24	26.4	52.8	10	84	376
26	28.5	57	10.9	91	481
28	31	62	11.7	98	603
30	33.1	66.2	12.5	105	735
32	35.2	70.4	13.4	112	897
34	37.8	75.6	14.2	119	1080
36	39.8	79.6	15	126	1275
38	41.9	83.8	15.8	133	1490
40	44	88	16.6	140	1734
42	46.2	92.4	17.5	147	1940
44	48.4	96.8	18.3	154	2314
46	50.6	101.2	19.2	161	2557
48	52.8	105.6	20	168	3010
50	55	110	20.8	175	3400
52	57.2	114.4	21.6	182	3813
54	59.4	118.8	22.5	189	4120
56	61.6	123.2	23.3	196	4772
58	63.8	127.6	24.2	203	5200
60	66	132	25	210	5880

4

5

6

7

8

9

10

11

12

13

14

15

16

17

18

19

20